

# Söll GlideLoc® Guide Rails

- Vertical fall protection system
- Certified according to EN 353-1: 00 and CNB/P/11.073



Subject to technical change. Please follow our maintenance and fitting instructions.

# Söll GlideLoc® Guide rails

## Guide rail

- For vertical application
- With connector
- Mounting distance: recommended 1,400 mm - max. 1,680 mm
- Max. section length 4,480 mm

Material: Anodised aluminium  
Profile 52 x 33 mm

Weight: Approx. 1.6 kg/m

**Part no. FS-SAL<rail length in mm>**

Material: Hot-dip galvanised steel

Profile 50 x 32 mm

Weight: Approx. 3.7 kg/m

**Part no. FS-SST<rail length in mm>**

Material: Pickled stainless steel

Profile 50 x 32 mm

Weight: Approx. 3.7 kg/m

**Part no. FS-SA4<rail length in mm>**

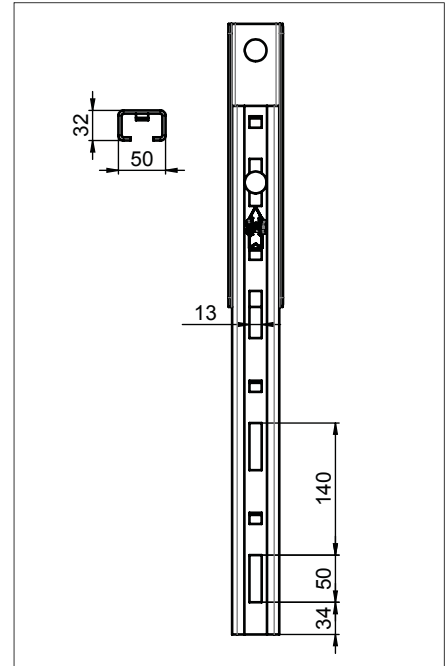

## Guide rail

- For vertical application
- With connector
- Mounting distance: recommended 1,400 mm - max. 1,680 mm
- Max. section length 4,480 mm

Material: Anodised aluminium  
Profile 52 x 33 mm

Weight: Approx. 1.6 kg/m

**Part no. FS-SAL<rail length in mm>**

Material: Hot-dip galvanised steel

Profile 50 x 32 mm

Weight: Approx. 3.7 kg/m

**Part no. FS-SST<rail length in mm>**

Material: Pickled stainless steel

Profile 50 x 32 mm

Weight: Approx. 3.7 kg/m

**Part no. FS-SA4<rail length in mm>**

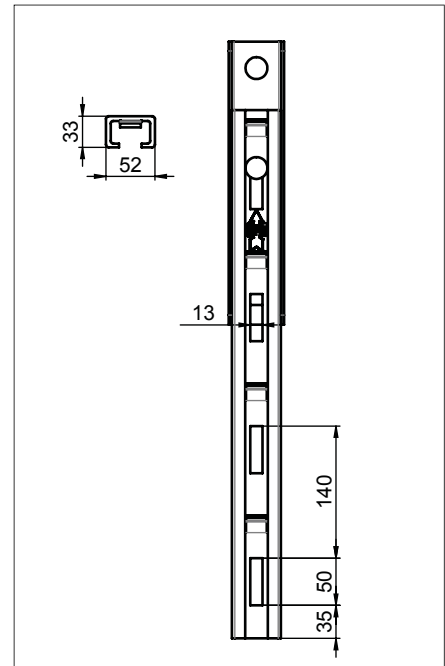
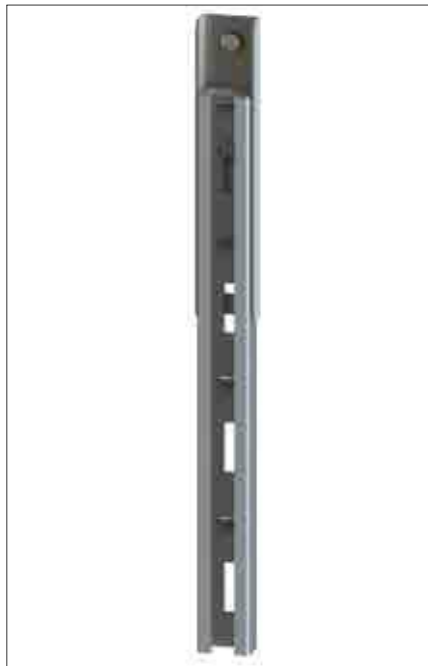

Subject to technical change. Please follow our maintenance and fitting instructions.

# Söll GlideLoc® Guide rails

## Connector

- To connect guide rails
- Complete with all mounting elements
- Included in the delivery of each guide rail

For steel guide rails

Material: Steel,  
hot-dip galvanised

Weight: 0.9 kg/each

**Part no. 17372**

For stainless steel guide rails

Material: Stainless steel,  
pickled

Weight: 0.9 kg/each

**Part no. 17988**

For aluminium guide rails

Material: Stainless steel,  
pickled

Weight: 0.9 kg/each

**Part no. 17055**

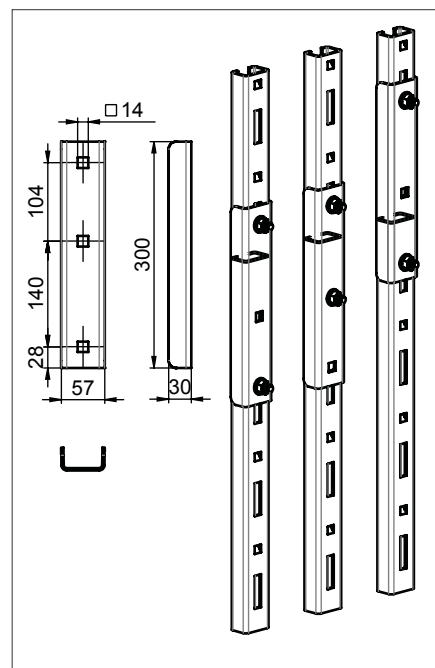

## Connector, internal

- Only for aluminium guide rails
- To compensate for different lengths
- Gap width max. 50 mm

Material: Stainless steel,  
pickled

Weight: 0.2 kg/each

**Part no. 25589**

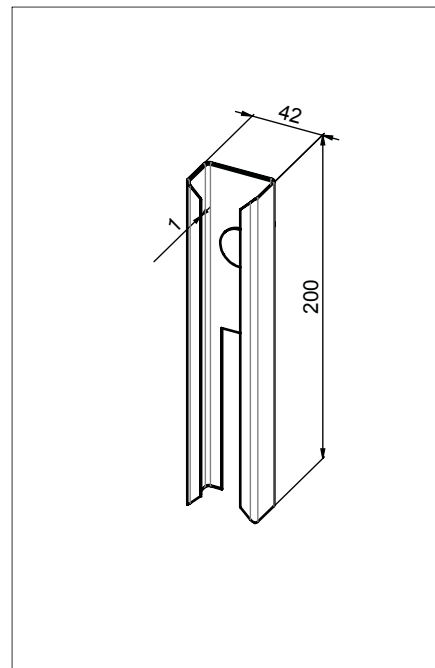

Subject to technical change. Please follow our maintenance and fitting instructions.

## Bending steel/stainless steel and aluminium guide rails

### Required information for planning:

Bending guide rail, hot-dip galvanised steel  
Bending guide rail, stainless steel, pickled  
Bending guide rail, anodised aluminium

Part no. FS-SST-<type>  
Part no. FS-SA4-<type>  
Part no. FS-SAL-<type>

### Length of guide rail to be bent

Type 1

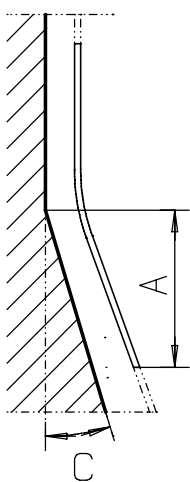

Type 2

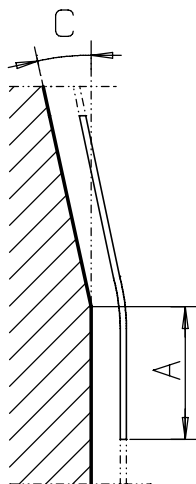

Type 3

Type 4

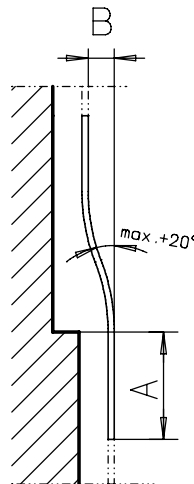

Type 5

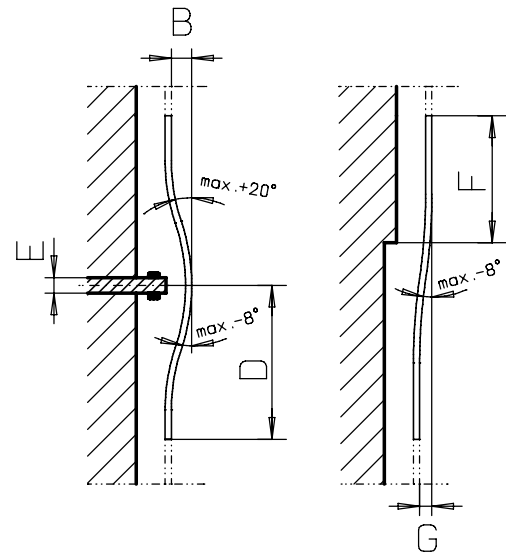

A = Bottom edge of ladder to salient point of structure (mm)  
B = Offset (mm)  
C = Angle (max. 15°)

D = Bottom edge to centre of obstruction (mm)  
E = Width of obstruction (mm)  
F = Upper edge of ladder to offset (mm)  
G = Offset (max. 260 mm)

### NB:

The smallest bending radius for steel/stainless steel guide rails is 1,000 mm.

The smallest bending radius for aluminium guide rails is 2,250 mm.

The extent of the bending depends on the bending radius and angle (type 1 + 2) or offset (type 3 - 5).

The surcharge for bending is calculated by bending type and offset.

Subject to technical change. Please follow our maintenance and fitting instructions.

# Söll GlideLoc® guide rails

## End-stops

### End-stop, top/bottom

- Prevents the fall arrester from either being inserted incorrectly or accidentally slipping out of the guide rail
- Complete with all mounting elements

Material: Stainless steel, pickled  
Weight: 0.3 kg/each  
Part no. **26027**

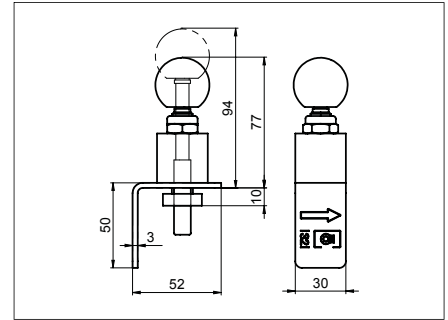

### Rigid end-stop

- Prevents the fall arrester from being taken out of the guide rail
- Complete with all mounting elements

Material: Stainless steel, pickled  
Weight: 0.2 kg/each  
Part no. **11634**

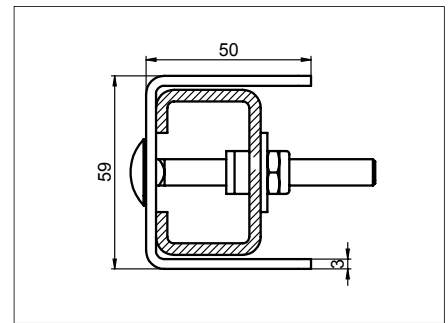

### End-stop, top/bottom side

- Prevents the fall arrester from either being inserted incorrectly or accidentally slipping out of the guide rail
- Complete with all mounting elements
- Used for:
  - Ladder projection < 150 mm
  - Mounting with reinforcement suitable for top and bottom use

Material: Stainless steel, pickled  
Weight: 0.2 kg/each  
Part no. **27136**

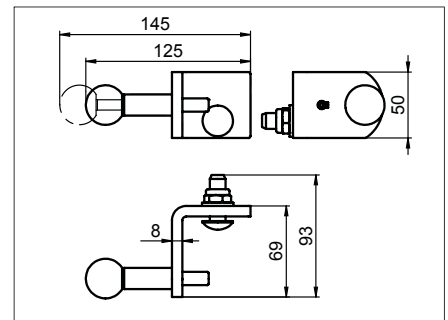

Subject to technical change. Please follow our maintenance and fitting instructions.

# Söll GlideLoc® guide rails

## Mounting elements

### Clamp, straight

- For retrofitting guide rails on ladders with rungs made of angle steel, U or hollow profiles
- Complete with all mounting elements
- Support structure and/or wall mounting must be checked to ensure sufficient strength
- Suitable for all rung distances
- Please indicate dimension 'A' when ordering

#### For angle profiles

Material: Steel, hot-dip galvanised  
Weight: Depends on size  
**Part no. 26791**

#### For square/U-rungs

Material: Steel, hot-dip galvanised  
Weight: Depends on size  
**Part no. 26761**

Stainless steel available upon request

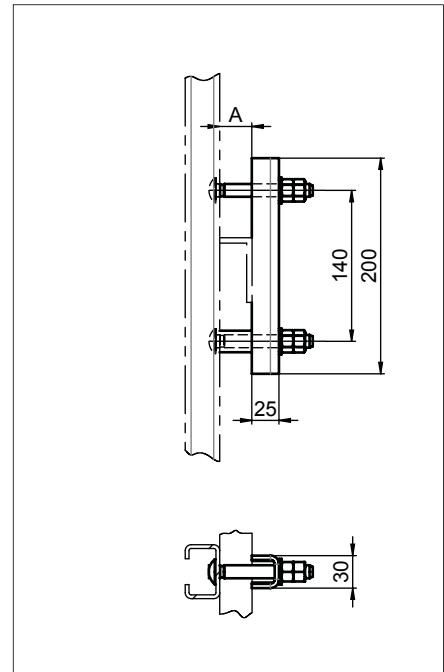

### Shim

- To compensate for different heights of individual rungs
- Clamping rail screw length must be adapted as necessary

Material: Steel, hot-dip galvanised

d = 5 mm  
Weight: 0.4 kg/each  
**Part no. 18861**

d = 3 mm  
Weight: 0.2 kg/each  
**Part no. 18860**

Material: Stainless steel, pickled

d = 5 mm  
Weight: 0.4 kg/each  
**Part no. 18863**

d = 3 mm  
Weight: 0.2 kg/each  
**Part no. 18862**

d = 2 mm  
Weight: 0.2 kg/each  
**Part no. 18859**

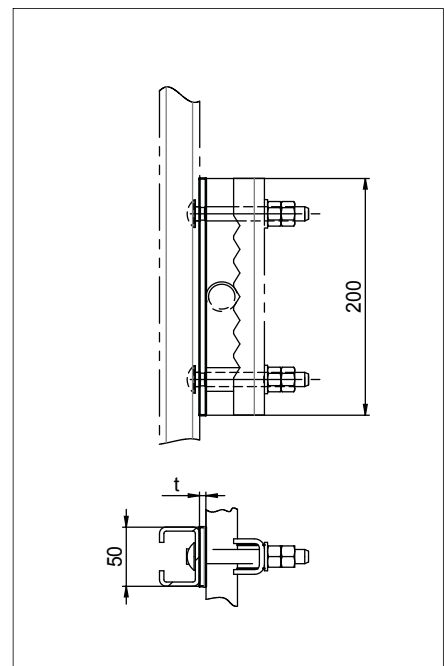
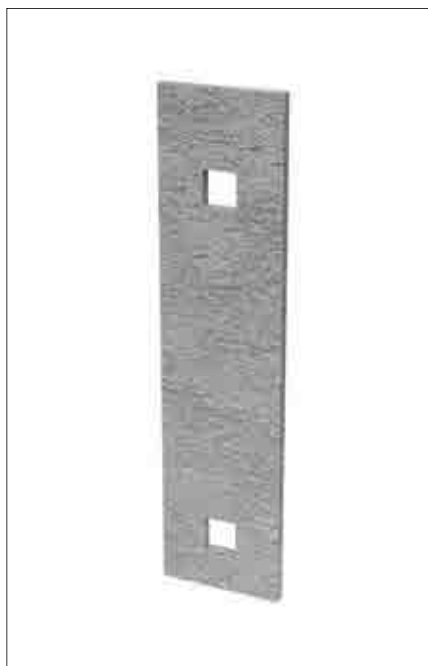

Subject to technical change. Please follow our maintenance and fitting instructions.

# Söll GlideLoc® guide rails

## Mounting elements

### Clamp

- For retrofitting on ladders or step irons
- Complete with all mounting elements
- Support structure and/or wall mounting must be checked to ensure sufficient strength
- Suitable for all rung distances

Material: See table

Weight: Depends on size

Part no. See table



Steel, hot-dip galvanised

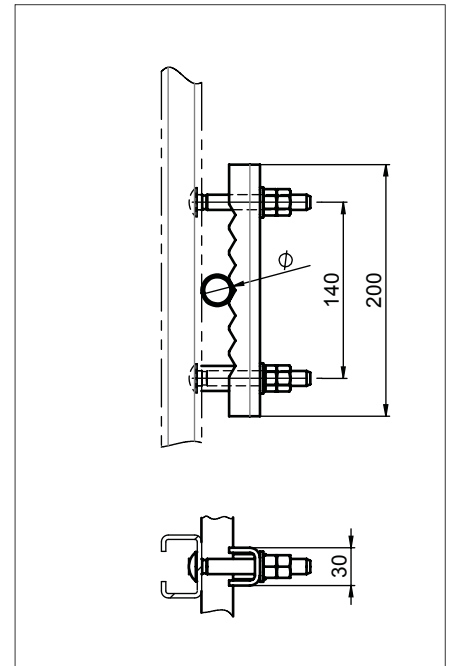

Steel, hot-dip galvanised	Part no.	Stainless steel 1.4571	Part no.
Screw length M12 x 80 for rung diameter - 25 mm	10903	Screw length M12 x 70 for rung diameter - 25 mm	14809
Screw length M12 x 90 for rung diameter 26 - 35 mm	14804	Screw length M12 x 80 for rung diameter 26 - 35 mm	14813
Screw length M12 x 100 for rung diameter 36 - 45 mm	14805	Screw length M12 x 90 for rung diameter 36 - 45 mm	14814
Screw length M12 x 110 for rung diameter 46 - 55 mm	14806	Screw length M12 x 100 for rung diameter 46 - 55 mm	14815
Screw length M12 x 120 for rung diameter 56 - 65 mm	14807	Screw length M12 x 120 for rung diameter 56 - 70 mm	14816

Subject to technical change. Please follow our maintenance and fitting instructions.

# Söll GlideLoc® guide rails

## Mounting elements

### Bracket

- For lateral mounting of guide rails on step irons
- Only for step irons with a diameter of 20 to 25 mm
- Complete with all mounting elements

Material: Steel, hot-dip galvanised

Weight: 1.7 kg/each

**Part no. 11319**

Material: Stainless steel, pickled

Weight: 1.7 kg/each

**Part no. 17989**

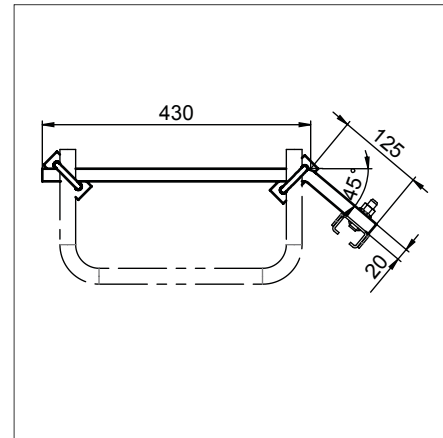

### Clamp

- For mounting on existing safety ladders with side rails
- Complete with all mounting elements
- Standard:  
Dimension 'W' = max. 60 mm  
Dimension 'H' = max. 15 mm

Material: Steel, hot-dip galvanised

Weight: 1.0 kg/each

**Part no. 11382**

Material: Stainless steel, pickled

Weight: 1.0 kg/each

**Part no. 16847**

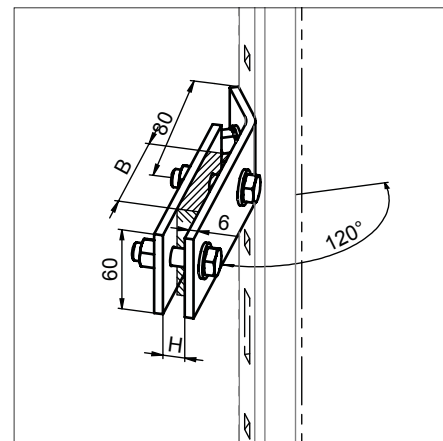

### • Customisation:

When ordering please specify dimension 'H' and 'W'

Material: Hot-dip galvanised steel

Weight: Depends on size

**Part no. 19091**

Material: Stainless steel, pickled

Weight: Depends on size

**Part no. 21284**

Subject to technical change. Please follow our maintenance and fitting instructions.



# Söll GlideLoc® guide rails

## Mounting elements

### Clamp

- For mounting on I/U-supports
- When ordering please specify dimensions 'h' and 'b'
- Only for use in conjunction with end-stop, side (part no. 27136)

Material: Steel, hot-dip galvanised  
Weight: Depends on size  
**Part no. 23961**

Material: Stainless steel, pickled  
Weight: Depends on size  
**Part no. 26665**

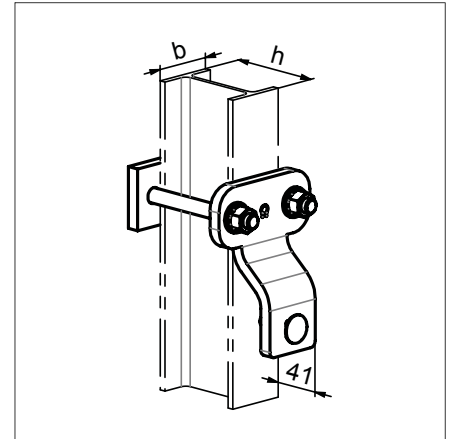

### Rung bracket

- For mounting on aluminium ladders
- Complete with all mounting elements
- For rung distance 80 mm only

Material: Pickled stainless steel  
Weight: Approx. 0.2 kg/each  
**Part no. See table**

Rung dimensions 'D' x 'H' in mm	Part no.
20x20	26944
21x21	26826
22x22	Upon request
23x23	Upon request
24x24	Upon request
25x25	27003
25x34	26189
26x26	Upon request
27x27	Upon request
28x28	26318
29x29	27367
29x27	25588
30x30	26067
31x31	25790

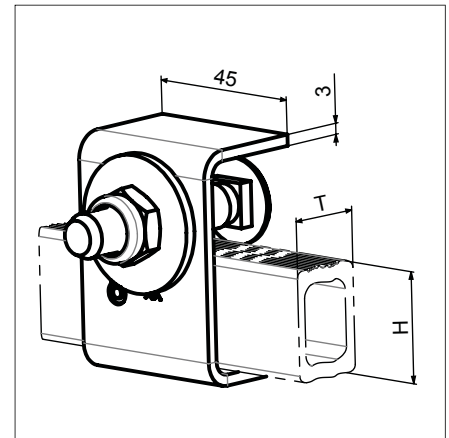

Subject to technical change. Please follow our maintenance and fitting instructions.

# Söll GlideLoc® guide rails

## Mounting elements

### Clamp

- For mounting on side rails with diameter 20 - 70 mm
- Complete with all mounting elements
- Please indicate tube diameter when ordering

Material: Steel, hot-dip galvanised  
Weight: 1.9 kg/each  
Part no. **18363**

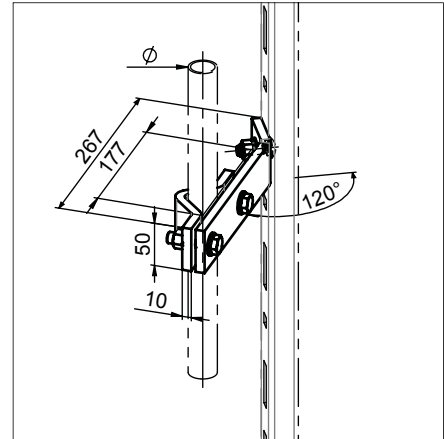

### Bracket

- Complete with all mounting elements
- Support structure must be checked to ensure sufficient strength

Material: Steel, hot-dip galvanised  
Weight: 0.5 kg/each  
Part no. **11102**

Material: Stainless steel, pickled  
Weight: 0.5 kg/each  
Part no. **16838**

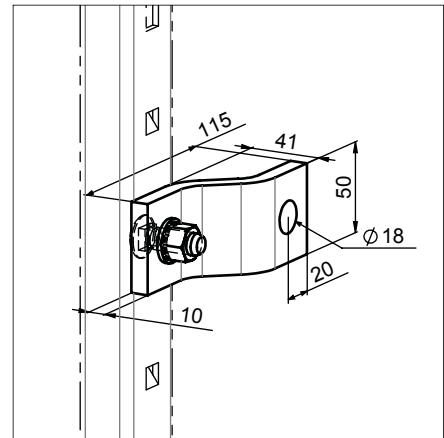

### Bracket

- For mounting on side rails from angle profile up to 50 x 50 mm
- Complete with all mounting elements

Material: Steel, hot-dip galvanised  
Weight: 1.1 kg/each  
Part no. **17228**

Other sizes available upon request

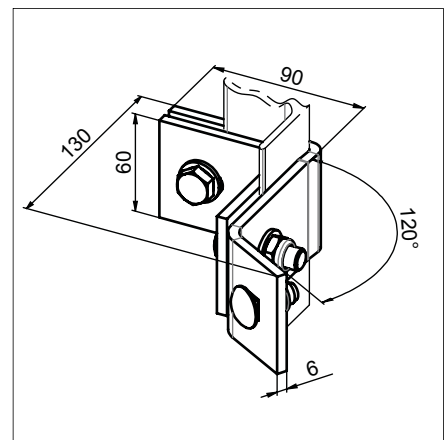

Subject to technical change. Please follow our maintenance and fitting instructions.

# Söll GlideLoc® guide rails

## Footrests

### Footrest

- Pivotal
- For mounting on step irons with a diameter of max. 20 mm
- Complete with all mounting elements

Material: Steel, hot-dip galvanised

Weight: 14.5 kg/each

**Part no. 16124**

Material: Stainless steel, pickled

Weight: 14.5 kg/each

**Part no. 18008**

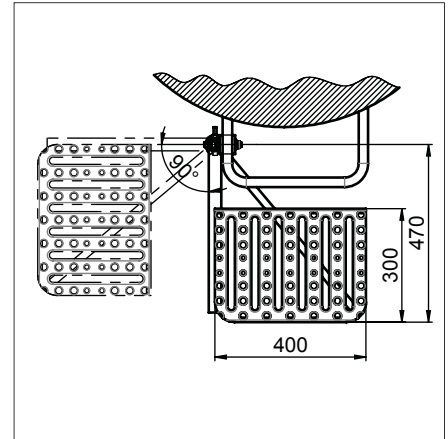

### Footrest

- Pivotal
- For mounting on side rails with a width of max. 50 mm
- Complete with all mounting elements

Weight: 17 kg/each

Hinge on left side

Material: Steel, hot-dip galvanised

**Part no. 21516**

Hinge on right side

Material: Steel, hot-dip galvanised

**Part no. 21520**

Stainless steel available upon request

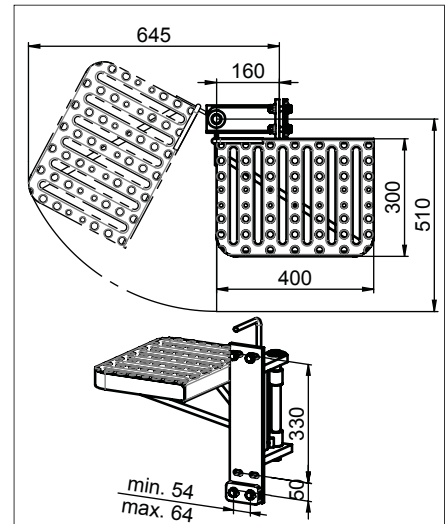

### Folding footrest

- Complies with DIN 18799
- Complete with all mounting elements
- Clearance of at least 0 mm between rungs
- Rung diameter: max. 30 mm

Material: Steel, hot-dip galvanised

Weight: 4.4 kg/each

**Part no. 23724**

Stainless steel available upon request

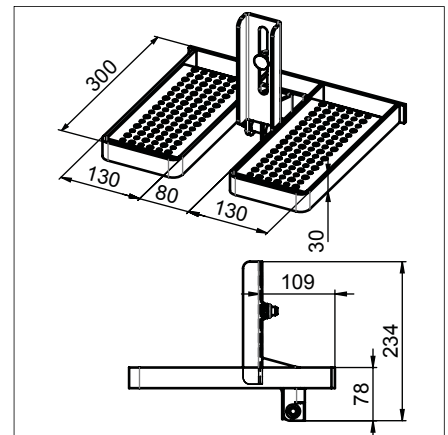

**Footrests** for climbways with reinforcement available upon request

Subject to technical change. Please follow our maintenance and fitting instructions.

# Söll GlideLoc® guide rails

## Exit section

### Exit section

- To be installed within the climbway
- To remove or insert the fall arrester
- Rung distance:  
Min. 250 mm  
Max. 320 mm
- Rung diameter max. 4 mm
- Comes with single-use mounting tool

Weight: 3.7 kg/each

Material: Steel, hot-dip galvanised

**Part no. 11317**

Material: Stainless steel, pickled

**Part no. 16978**

Special sizes available upon request  
(please include diagrams with ladder cross-section)

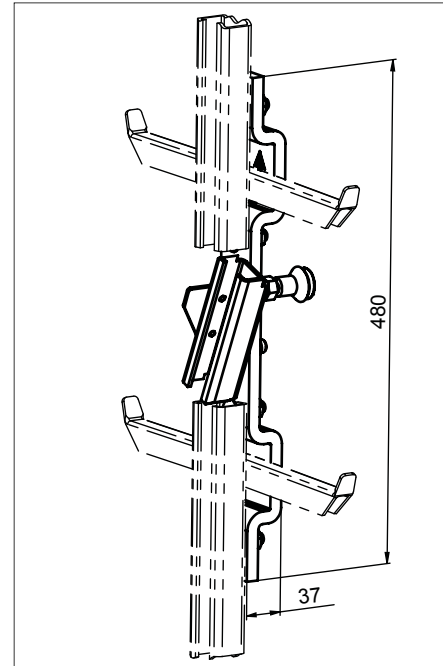

### Possible installation heights in a ladder section of 4,480 mm:

Height from bottom ladder section	
560 mm	Between 2nd and 3rd rung
840 mm	Between 3rd and 4th rung
1,120 mm	Between 4th and 5th rung
1,400 mm	Between 5th and 6th rung
1,680 mm	Between 6th and 7th rung
1,960 mm	Between 7th and 8th rung
2,240 mm	Between 8th and 9th rung
2,520 mm	Between 9th and 10th rung
2,800 mm	Between 10th and 11th rung
3,080 mm	Between 11th and 12th rung
3,360 mm	Between 12th and 13th rung
3,640 mm	Between 13th and 14th rung
3,920 mm	Between 14th and 15th rung

The recommended installation height is approx. 1,000 mm above the top edge of the footrest

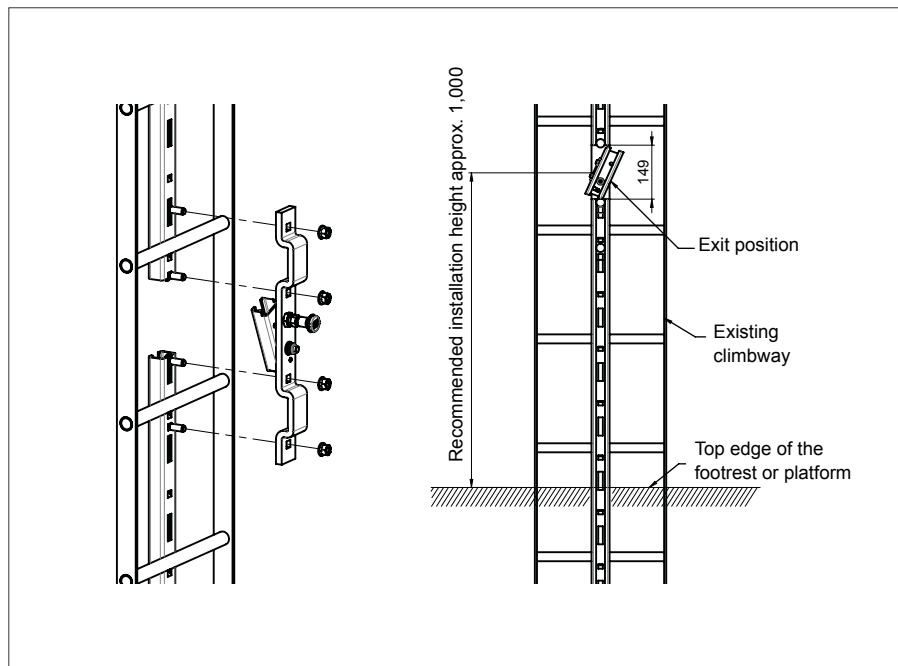

Subject to technical change. Please follow our maintenance and fitting instructions.

# Söll GlideLoc® guide rails

## Turntable

### Turntable

- For safe transfer from vertical to horizontal and vice versa
- With aluminium profile for supporting the fall arrester
- Please specify the guide rail profile of the horizontal and vertical system

Material: Stainless steel, pickled

Weight: 4.2 kg/each

**Bending radius of horizontal guide rail > 1,000 mm**

**Part no. 11607**

**Bending radius of horizontal guide rail < 1,000 mm**

**Part no. 20349**

Factory assembly on guide rail

**Part no. 16884**

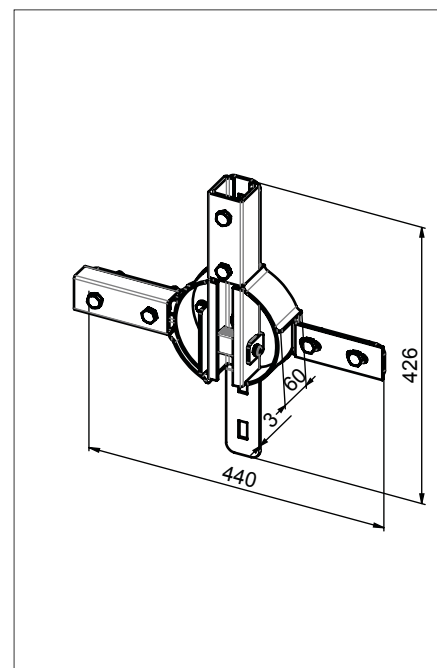

### Ho-Ver turntable

- For safe transfer from vertical to horizontal and vice versa
- The direction of travel can only be changed to the left or to the right
- Available also with release option in the pivoting part
- The combination of two or more turntables is only permitted if checked by the manufacturer and specifically approved in writing

Material: Stainless steel, pickled

Weight: 3.7 kg/each

**Part no. 22322**

#### With release option

Material: Stainless steel, pickled

Weight: 3.7 kg/each

**Part no. 22495**

(not shown)

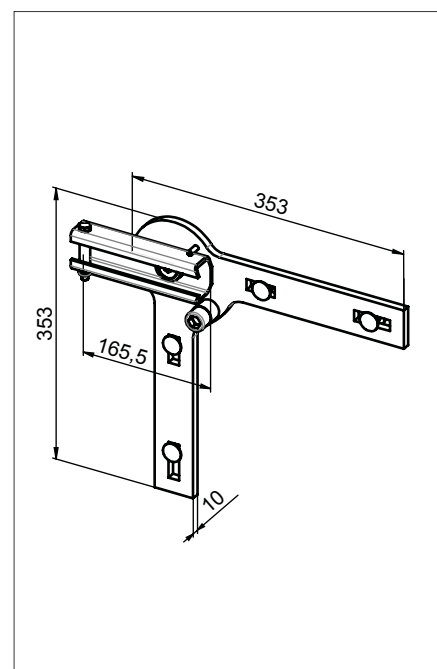

Subject to technical change. Please follow our maintenance and fitting instructions.

# Söll GlideLoc® guide rails

## Accessories

### Mounting bracket with adjustable projection

- Projection: 100 mm to 160 mm
- To be used for mounting turntable only
- Screws for installation on the turntable not included

Material: Steel, hot-dip galvanised

Weight: 1.6 kg/each

**Part no. 10867**

Material: Stainless steel, pickled

Weight: 1.6 kg/each

**Part no. 11591**

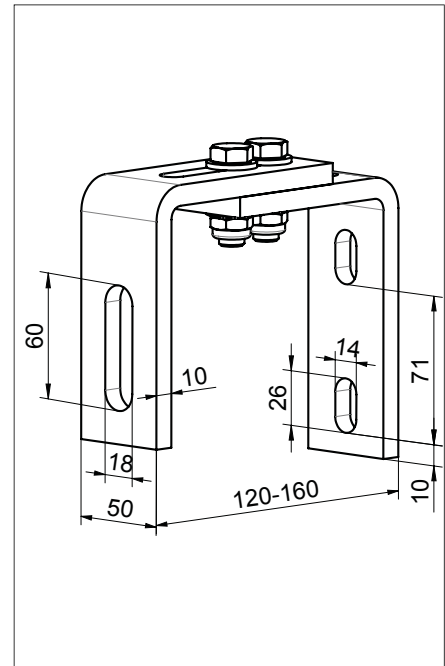

### Mounting bracket with adjustable projection

- Projection: 160 mm up to 200 mm
- To be used for mounting turntable only
- Screws for installation on the turntable not included

Material: Steel, hot-dip galvanised

Weight: 1.8 kg/each

**Part no. 10869**

Material: Stainless steel, pickled

Weight: 1.8 kg/each

**Part no. 15250**

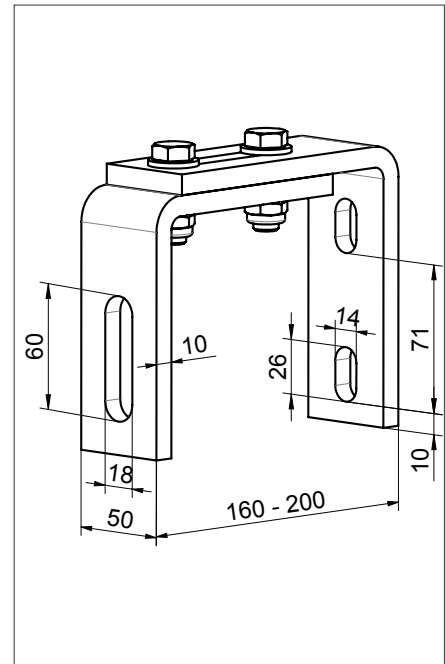

Subject to technical change. Please follow our maintenance and fitting instructions.

# Söll GlideLoc® guide rails

## Manhole entry device

### Manhole entry device

- For safe entry into manholes
- Only use together with lower part for manhole entry device
- This device can be moved from one manhole ladder to another and locked.

Material: Stainless steel, pickled  
Weight: 7.0 kg/each  
Part no. 17065

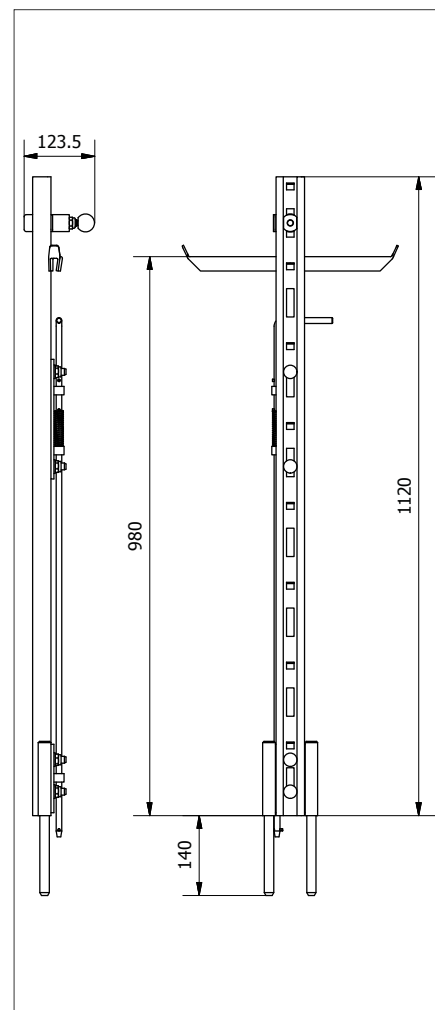

### Lower part for manhole entry device

- Fixed to the rear of the fixed guide rail

Material: Stainless steel, pickled  
Weight: 0.8 kg/each  
Part no. 16191

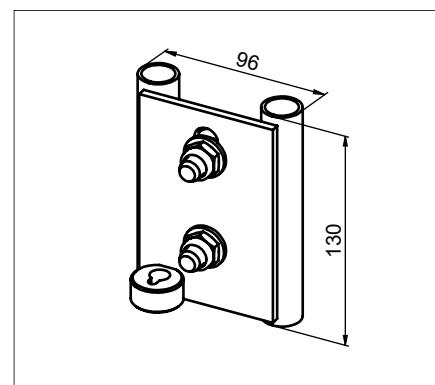

Subject to technical change. Please follow our maintenance and fitting instructions.

# Söll GlideLoc® guide rails

## Accessories

### Reinforcement

- Required when the distance between last mounting point and the top end of the guide rail exceeds 380 mm
- Must be bolted onto the profile every 560 mm
- Must extend down over at least two mounting brackets
- Complete with all mounting elements

For guide rails made of steel, hot-dip galvanised steel/stainless steel, pickled:  
Square tube 50 x 30 x 3 mm

Weight: Approx. 3.3 kg/m

Material: Steel,  
hot-dip galvanised

**Part no. HV-ST-  
length in mm**

Material: Stainless steel,  
pickled

**Part no. HV-A4-  
length in mm**

For guide rails made of anodised aluminium:  
Rectangular tube 50 x 50 x 4 mm

Weight: Approx. 1.9 kg/m

Material: Anodised aluminium

**Part no. HV-AL-  
length in mm**

### Identification plate

- For fall protection device - 'Söll GlideLoc®' fall protection systems
- Cover plate assembled in factory
- Must be affixed to each access point
- Languages: D/E/F/ES

Material: Aluminium

Weight: 0.06 kg/each

**Part no. 19876 not engraved**

### Engraved:

Part no.	Guide rail
20854	Steel, hot-dip galvanised
20855	Stainless steel, pickled
20850	Anodised aluminium

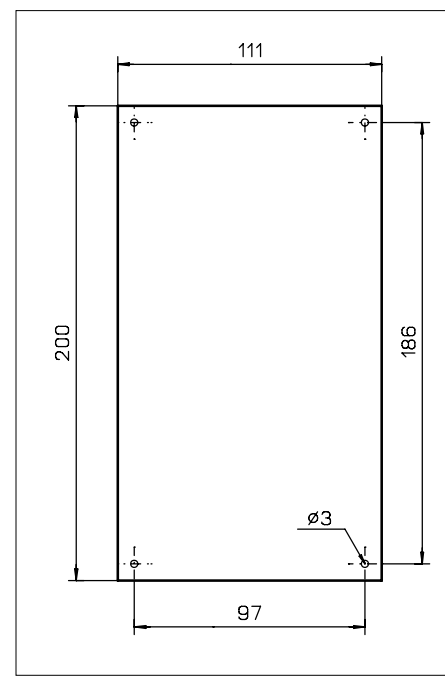
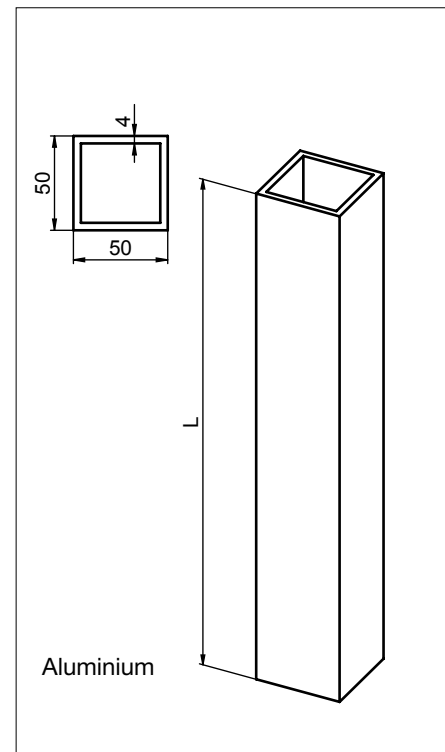
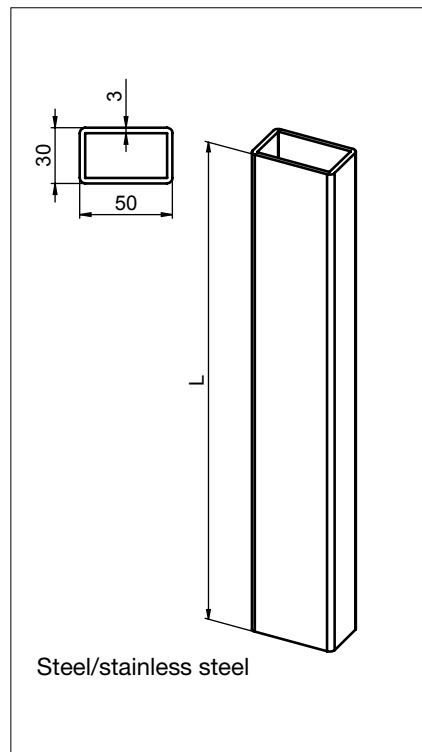

Subject to technical change. Please follow our maintenance and fitting instructions.



# Söll GlideLoc® guide rails

## Accessories

### Special bolt

- Special bolt for fixing Söll GlideLoc ladders and guide rails
- Complete with connector
- Other dimensions available upon request

<u>Material:</u>	Steel, hot-dip galvanised	<u>Material:</u>	Stainless steel, pickled
<b>M 12 x 30</b>	<b>Part no. 15667</b>	<b>M 12 x 30</b>	<b>Part no. 15669</b>
Weight:	0.06 kg/each	Weight:	0.06 kg/each
<b>M 12 x 35</b>	<b>Part no. 15850</b>	<b>M 12 x 35</b>	<b>Part no. 15858</b>
Weight:	0.06 kg/each	Weight:	0.06 kg/each
<b>M 12 x 40</b>	<b>Part no. 15851</b>	<b>M 12 x 40</b>	<b>Part no. 15859</b>
Weight:	0.07 kg/each	Weight:	0.07 kg/each
<b>M 12 x 50</b>	<b>Part no. 15852</b>	<b>M 12 x 50</b>	<b>Part no. 15860</b>
Weight:	0.07 kg/each	Weight:	0.07 kg/each
<b>M 12 x 60</b>	<b>Part no. 15853</b>	<b>M 12 x 60</b>	<b>Part no. 15861</b>
Weight:	0.08 kg/each	Weight:	0.08 kg/each
<b>M 12 x 70</b>	<b>Part no. 15854</b>	<b>M 12 x 70</b>	<b>Part no. 15862</b>
Weight:	0.09 kg/each	Weight:	0.09 kg/each
<b>M 12 x 80</b>	<b>Part no. 15855</b>	<b>M 12 x 80</b>	<b>Part no. 15863</b>
Weight:	0.09 kg/each	Weight:	0.1 kg/each
<b>M 12 x 90</b>	<b>Part no. 15856</b>	<b>M 12 x 90</b>	<b>Part no. 15864</b>
Weight:	0.1 kg/each	Weight:	0.11 kg/each
<b>M 12 x 100</b>	<b>Part no. 15857</b>	<b>M 12 x 100</b>	<b>Part no. 15865</b>
Weight:	0.11 kg/each	Weight:	0.12 kg/each

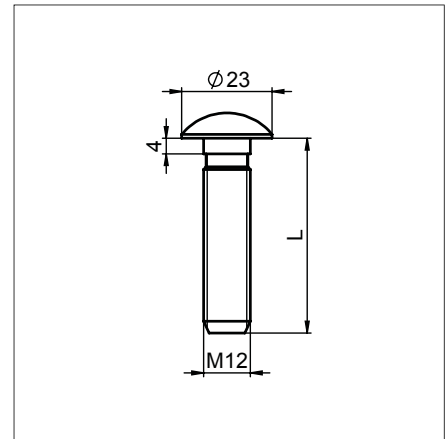

Hot-dip galvanised steel version



### Ice scraper

- For removal of frost and ice from Söll GlideLoc guide rails
- Can be used for all profiles
- Removes ice on the inside and outside of the running surfaces of the guide rails
- Anodised aluminium body
- Spring steel blades

Weight: 0.5 kg/each  
Part no. 18072



Subject to technical change. Please follow our maintenance and fitting instructions.

# Söll GlideLoc® Fall arresters

## Söll Comfort fall arrester

- Complies with EN 353-1: 00 ; CNB/P/11.073
- With energy-absorbing element
- Self-closing swivel safety karabiner and three self-locking aluminium elements (left figure)
- For use with or without leaning back
- For vertical and horizontal use in all Söll GlideLoc fall protection systems
- Aluminium body, stainless steel safety catch

Weight: 1.1 kg/each

Part no. 22697

## Söll Comfort fall arrester

- With aluminium screw safety karabiner (right figure)

Weight: 1.2 kg/each

Part no. 22690

### Note:

Söll Comfort aluminium fall arresters must not be used in areas where explosions are possible.



## Söll Comfort fall arrester<sup>2</sup> (left figure)

- Base body, safety catch and self-locking safety karabiner are manufactured from saltwater-proof stainless steel

Weight: 1.2 kg/each

Part no. 23331

## Söll Universal II fall arrester (right figure)

- Complies with EN 353-1: 00 ; CNB/P/11.073
- Can be inserted and removed at any position
- Self-closing swivel safety karabiner and three self-locking aluminium elements
- For vertical and horizontal use in all Söll GlideLoc fall protection systems
- Fall arrester manufactured from stainless steel

Weight: 1.5 kg/each

Part no. 25805



Subject to technical change. Please follow our maintenance and fitting instructions.